



The Wiregrass Church Documentation Project

**The Wiregrass Archives
Troy University Dothan Campus**

Society of Florida Archivists, 2013
Presented by Marty Olliff

Wiregrass Archives Coverage



Four Phases

- Phase 1
 - Reconnaissance Survey of Buildings
- Phase 2
 - Demographics of Congregations
- Phase 3
 - Records Surveys of Churches
- Phase 4
 - Locate / Create Histories

Characteristics of Project

SCALABLE

“CHUNKABLE”

TRANSFERABLE

Finding Churches

**AL HomeTownLocator®**
... local information, resources & data

Dale County AL Churches

Gazetteer | Cities | Counties | Maps | ZIP Codes | **Features** | Land | Census | Schools | Search Alabama:

US Gazetteer > Alabama Gazetteer > Alabama Features > Dale County Features > Cultural Features Type: Churches

Dale County Cultural Features: Churches

 **ORDER PICK-UP & GO**

☐ Additions and/or corrections to the database are encouraged! [Simple Add/Edit Procedure.](#)

The **Local Search** on cities, towns and populated place pages will provide additional information for Churches.

Displaying 1 to 75 of 122 records Next ▶

Name	County	USGS Topo Map
Allen Chapel	Dale	Skipperville
Antioch Baptist Church	Dale	Pinckard
Ariton United Methodist Church	Dale	Ariton
Asbury United Methodist Church	Dale	Skipperville
Bethel Assembly of God Church	Dale	Ariton
Bethel Baptist Church	Dale	Daleville
Bethel United Methodist Church	Dale	Ewell
Browns United Methodist Church	Dale	Clopton
Calvary Church	Dale	Ozark
Campground Baptist Church	Dale	Ozark
Cedar Grove Church	Dale	Pinckard
Center Ridge Baptist Church	Dale	Ariton
Chalkhead Baptist Church	Dale	Ewell
Chapel of the Flags	Dale	Daleville
Christian Hill Church	Dale	Echo
Claybank Church	Dale	Ozark
Clayhatchee Church	Dale	Clayhatchee
Clopton United Methodist Church	Dale	Clopton
Corinth Free Will Baptist Church	Dale	Ewell
Daleville Church	Dale	Daleville
Dean Church	Dale	Ozark
Ebenezer Church	Dale	Enterprise NE
Echo United Methodist Church	Dale	Echo
Evergreen Church	Dale	Ariton
Ewell Assembly of God Church	Dale	Ewell
Ewell Baptist Church	Dale	Ewell
Faith Baptist Church	Dale	Enterprise
Faith Church	Dale	Ozark
Fifth Avenue Church	Dale	Daleville
First Assembly of God Church	Dale	Pinckard
First Assembly of Midland City Church	Dale	Midland City
First Baptist Church	Dale	Ozark
First Baptist Church of Kelly	Dale	Daleville
First Korean Baptist Church	Dale	Enterprise

Family History Records
[www.genealogybank....](#)
Locate Deceased Relatives With The Largest Obituary Archive Online!

Want to Become a Pastor?
[eLearners.com/Religi...](#)
Earn Your Religious Degree at Home. Request Free Program Info Today.

Highway Road Map
[www.MapsGalaxy.com](#)
Get Maps, Directions & Traffic Conditions With Free App!

Opioid Dependence Doctors
[TurnToHelp.com](#)
Find a doctor who can prescribe a private, in-office treatment.

www.hometownlocator.com

Phase 1

- “Windshield” Survey
 - Collect architectural and location data
 - Photos around all buildings
 - Footprint drawing where possible
- Three Alabama Counties
 - Dale
 - Henry
 - Houston

Three County Survey

n = 331

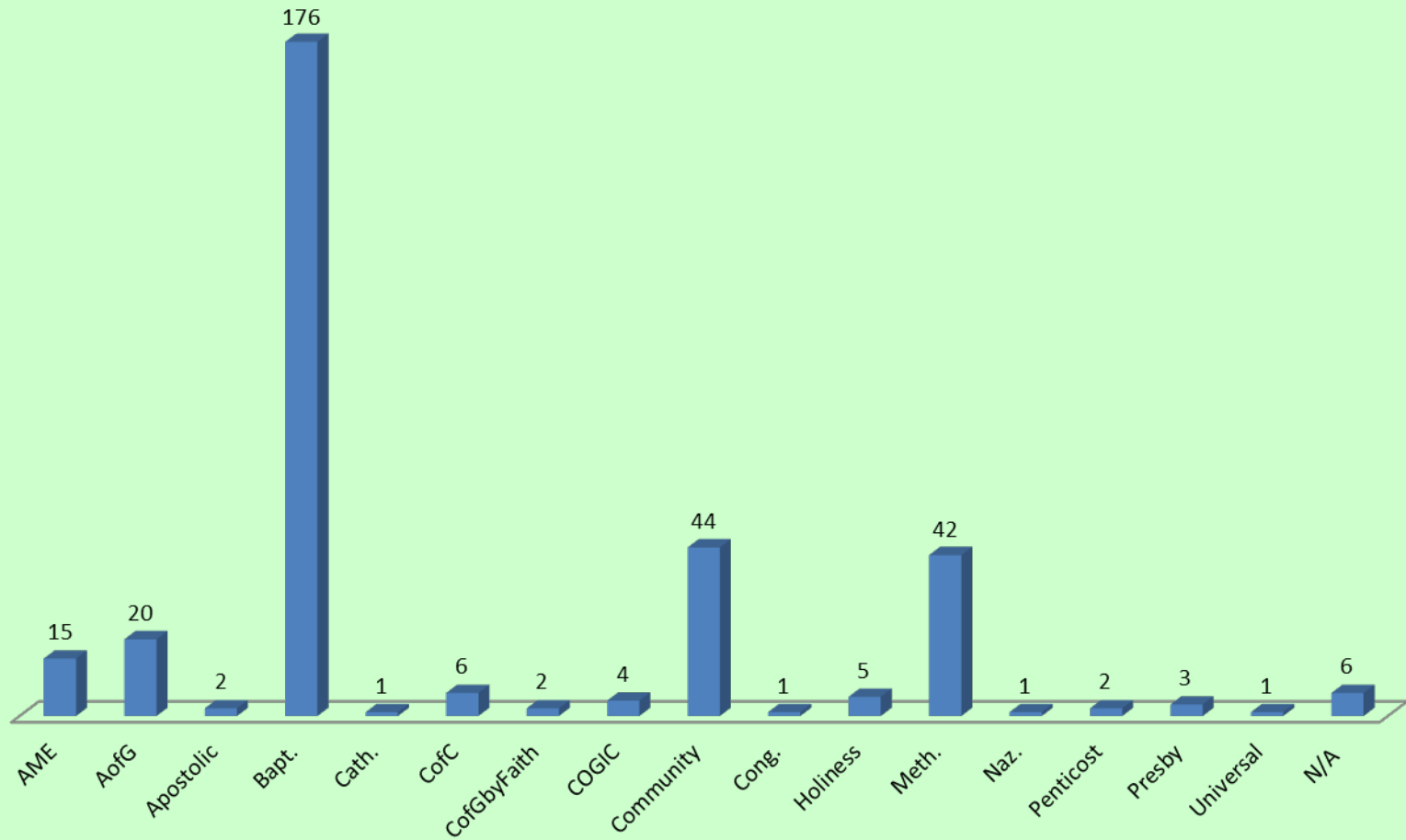

MS Access Data Form

Code	<input type="text"/>
County	<input type="text"/>
State	<input type="text"/>
Present Name	<input type="text"/>
Specific Location/Address	<input type="text"/>
City, Town, Township	<input type="text"/>
Zip Code	<input type="text"/>

Building Info	Congregation	Preparer Info
---------------	--------------	---------------

Other Names	<input type="text"/>	Roof Type/Material	<input type="text"/>
GPS Coordinates	<input type="text"/>	Number of Bays	<input type="text"/>
On Natl Register?	<input type="text"/>	Changes	<input type="text"/>
ON AL Register?	<input type="text"/>		
Historical District Name:	<input type="text"/>	Interior Condition	<input type="text"/>
Date building erected	<input type="text"/>	Exterior Condition	<input type="text"/>
Style or Design	<input type="text"/>	Preservation underway?	<input type="text"/>
Architect or Engineer	<input type="text"/>	Endangered?	<input type="text"/>
Builder or Contractor	<input type="text"/>	If endangered, explain	<input type="text"/>
Original Use	<input type="text"/>	Visible from Public Road?	<input type="text"/>
Lot Size	<input type="text"/>	Notes on Physical Description	<input type="text"/>
Owners' Name/Address	<input type="text"/>		
Local Contact Name/Address	<input type="text"/>	History / Significance	<input type="text"/>
Location of Additional Data	<input type="text"/>	Sources of Information	<input type="text"/>
Number of Stories	<input type="text"/>	Link to Map	<input type="text"/>
Document ID	<input type="text"/>	Link to Photo Page	<input type="text"/>

Phase 1 Product:

Webpage Antioch AG

Image Links

Antioch Assembly of God

Address	200 Antioch Ch Rd	Foundation	brick
City	Grangeburg / Ashford	Wall	brick
Zip Code		Roof	shingle
Other Names		Changes	yes
Original Use		Phys Desc	
Stories	1		

Photographs (Click to view larger image)



Footprint



Phase 1 Product:

Antioch AG Reference Image and “Footprint”

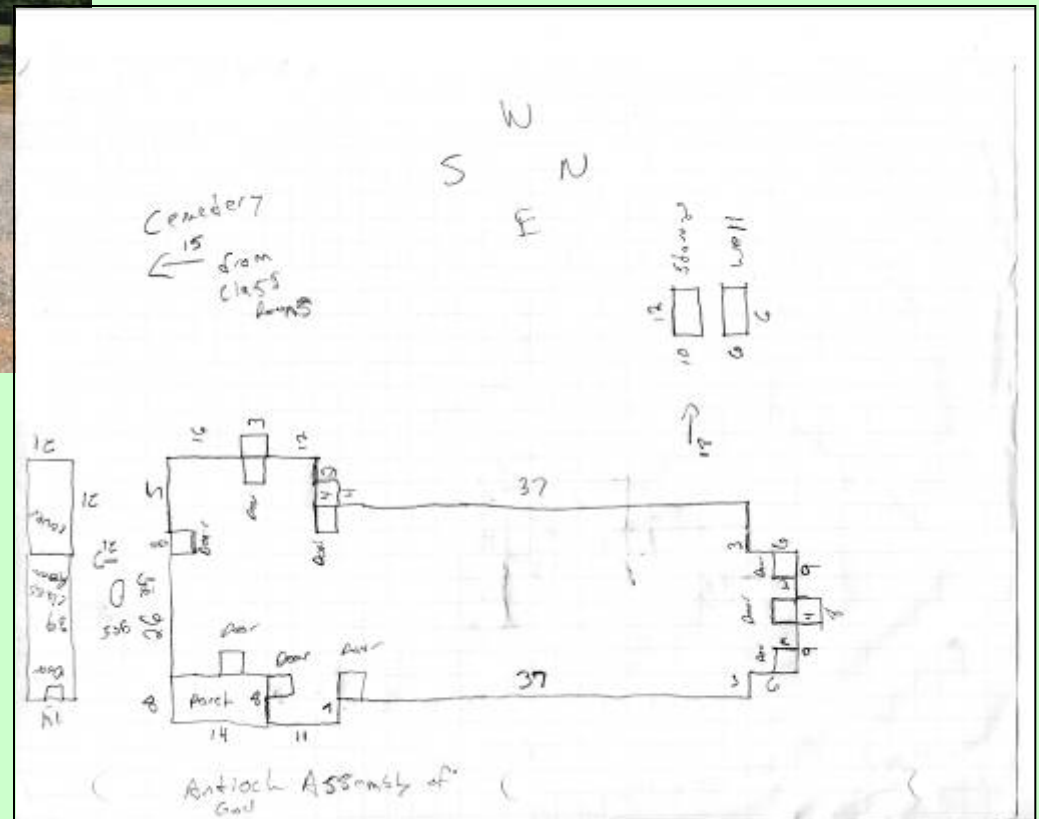

Phase 2: Congregational Demographics

- Responses: 77
- Questions:
 - Number
 - Ethnicities
 - Age Brackets
 - Occupations
 - Meeting Frequency
 - Leadership Type
 - Membership in association
 - Congregation history notes

Phase 3: Records Survey

- 97.4% in Phase 2 agreed to Phase 3
- Guidelines available online
 - UMC
 - Episcopalians
 - SBC
 - Presbyterians
 - Evangelical Lutherans

Phase 4: History

- Very few have written history
- Many have history committee
- Project has written one church history

Collaborative Archives?

- Each Agency Keeps Own Records / Mss
- “Central” Archivist Provides Services
 - Appraisal / Selection Advice
 - Preservation Advice & Vending
 - Description Beyond Finding Aid
 - Access Support
 - Mngt and Grant Coordination
- Serves Social Justice

