



Forward, Marsh!

Growing Ecology Collections at the
University of South Florida Libraries

Andy Huse, Archivist and Curator of Florida Studies

Sydney Jordan, Coordinator of LGBTQ+ Studies

John Clarke, Student Assistant for FLENH

Amanda Boczar, Curator, Digital Collections



UNIVERSITY of
SOUTH FLORIDA
Libraries

- The Green Swamp straddles five counties and feeds four major rivers
- From a distance, its waters don't seem to move much at all
- Yet fresh water percolates insistently from a natural spout in the aquifer
- In the hydrological cycle, it is a kind of rebirth

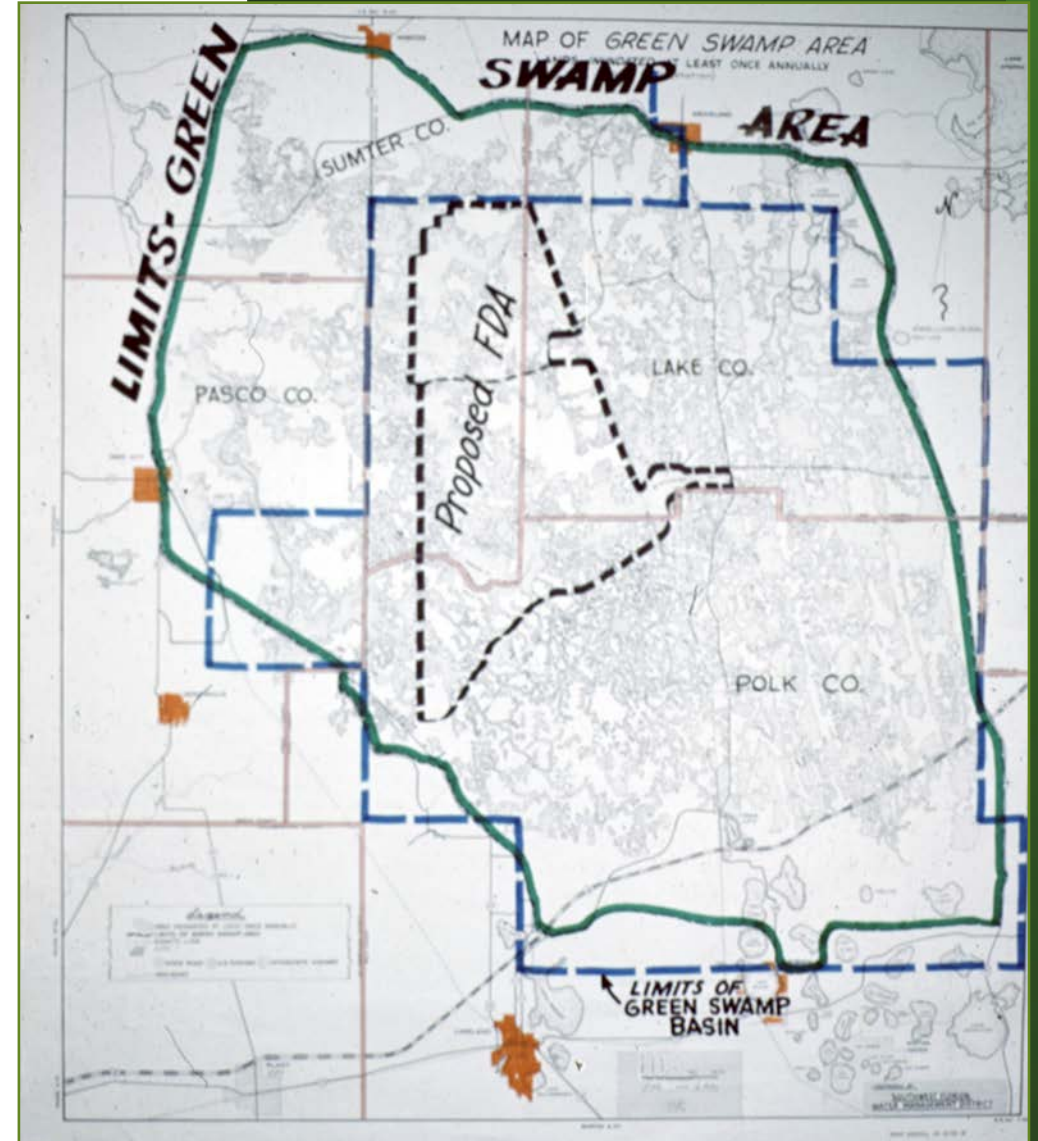

An aerial photograph showing a complex network of waterways and islands. The water is a deep blue, and the islands are covered in dense, green forest. The landforms are irregular and interconnected, creating a maze-like pattern of channels and peninsulas. The overall scene is a lush, natural landscape.

From this mysterious source the Hillsborough River supplies drinking water to millions and vital fresh water to the fragile estuaries in Tampa Bay



*Away down upon the Suwannee River
Far, far, away,
There's where my heart is turning ever
There's where the old folks stay.*

*All up and down the whole cr
Sadly I roam,
Still hoping for the old planta
And for the old folks at hom*

Drawing the Map

- Our experience of building ecological collections bears some resemblance to the Hillsborough River or other Florida waterways
- It begins slowly with no clear direction
- It finds a path in the landscape
- Twists in its path can impede progress (there are no straight rivers in nature)
- It flows into the ocean, freshening its environs

The Landscape

USF Special Collections

- Florida Studies a pillar of collections
- Emphasis on history and humanities
- USF Libraries and aspirations for ARL
- Failure of previous strategic initiatives in SPC
- *Consolidated of emphasis narrowed to:*
 - Florida Studies
 - USF Archives
 - Florida Environment and Natural History Collections
 - LGBTQ+ Studies
 - Children and Young Adult Literature
 - Journalism
 - Civil Rights





Growing Collections

- Staff open to new subjects and challenges
- The strength of a single thread
- Gradual/grudging buy-in from above
- Effective networking and large acquisitions: Audubon Florida
- Success inspires new strategic direction
- Florida Environment and Natural History (FLENH) prioritized in 2018

Swimming with the Current

- The scientific study of Florida is young, but maturing
- Records accumulating as activity intensifies and scholars retire
- Existing scientific publications are the tip of the iceberg, with old data/papers often left behind
- Neglected materials may be worthy of (re)discovery
- Statewide emphasis on STEM fields
- Challenges for non-STEM fields
- The Humanities: understanding the human condition

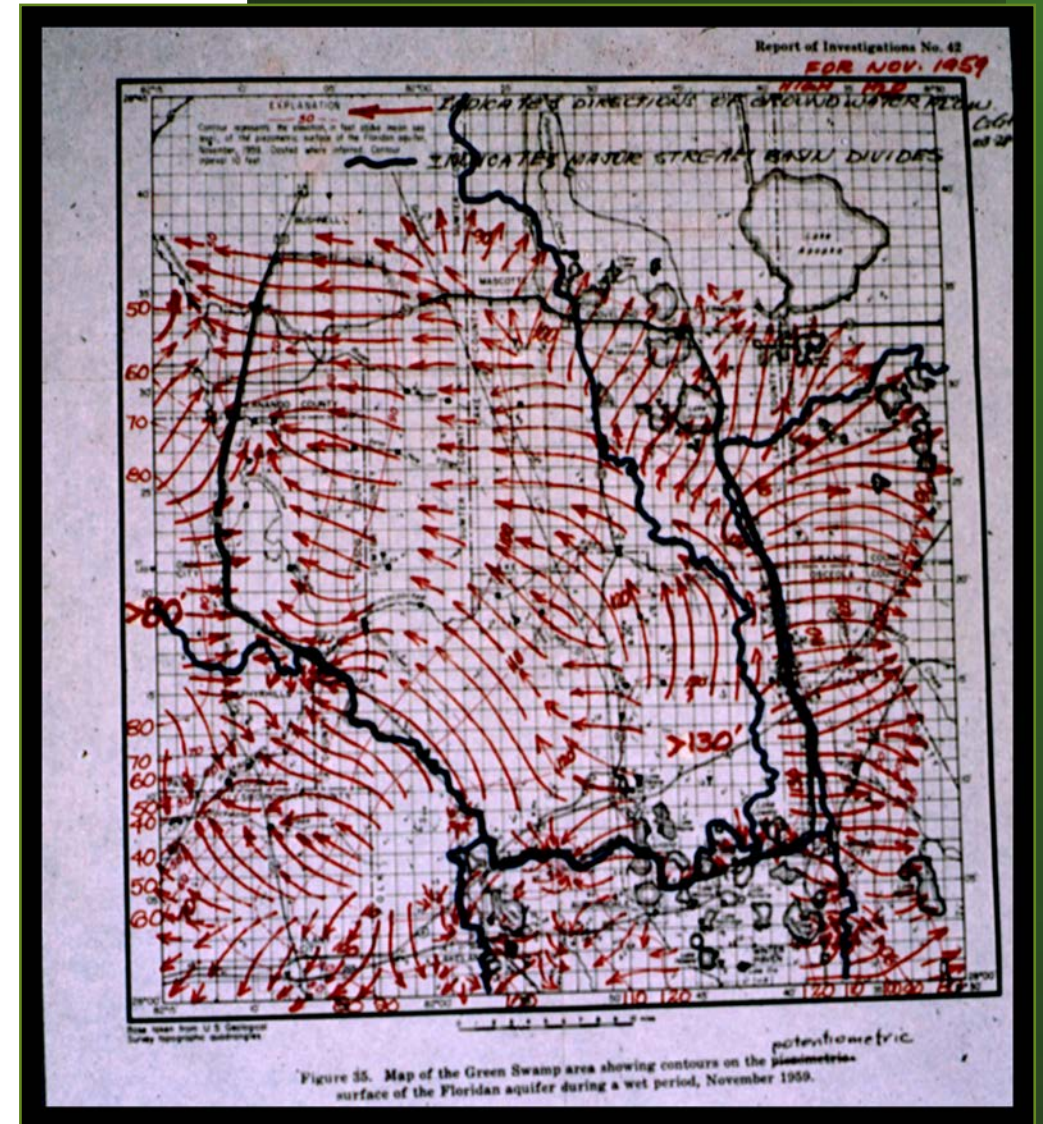

ing on Ocklawaha River, Fla.



Paddling with the Current

- Archives and Academic Libraries are uniquely positioned to preserve and enhance scientific papers
- Salvage the human side of scientific study through archival material
- Harvest contextual/scientific information/metadata directly from creators and donors
- Recontextualize existing Florida Studies collections: synergy
- Curation and creation: oral history and digital exhibits
- Make natural history and ecology approachable for non-science scholars
- Data Management and open access publishing

Symbiotic Relationships

- Memos of understanding / partners
- Usually cash-poor partners
- Ingestion of digital material
- Digitizing archival material
- Collaboration on grants, projects and events





Winding Rivers

- STEM and SPC expertise
- Digital aspirations vs. realities
- The metadata question
- Acquisitions: How much is enough?
- SPC gets attention/funding: [BIPs](#)
- Hiring new subject specialists

Making Connections

- Multiple software migrations and new capabilities
- Challenges of cleanup and establishing best practices
- Centralizing and categorizing
- Understanding researcher perspective

C-03. Florida Environment and Natural History Collections

← Record Group Identifier: C-03

← C-03. Florida Environment and Natural History Collections

As a strategic collecting area, Special Collections seeks Environmental and Natural History Research Collections that further understanding of environmental history of both Florida and beyond. Collections including, but not limited to, materials about the State of Florida, the Caribbean, and the Gulf of Mexico will strengthen existing holdings of Audubon Florida and the pioneering ornithologist Robert Porter Allen.

Found in 29 Collections and/or Records:

Spotlight: Florida's Phosphate Industry

The phosphate industry in Florida dates back to the late 19th century when Albertus Vogt, known as "The Duke of Dunnellon," discovered hard rock phosphate while managing water flow on his groves. This led to an era of development in Central Florida, in addition to the pebble phosphate industry. The 2021 leak at Manatee County's Piney Point phosphate plant has underscored the importance of studying historical documents and both past and present environmental impacts of the industry. The gallery below shows a preview of related materials from the [Skip Gandy collection](#), [Hampton Dunn collection](#), and [IMC Agrico Phosphate Company Collection](#).



Formalizing Links

- Improved specialized metadata
- Increasing keyword returns
- Linked bibliographies
- Importance of cross-training

Florida Field Naturalist: a Semi-annual Journal of the Florida Ornithological Society, 1973 - 1982

Item – Object: ENVR QL684.F6 F56 Identifier: 1

USF Libraries - Special Collections | Florida Ornithological Society Records (MS-2022-02) | Cataloged Publications | Florida Field Naturalist: a Semi-annual Journal of the Florida Ornithological Society, 1973 - 1982

USF SPECIAL COLLECTIONS-Tampa
Available, Environmental and Natural History Collection QL684.F6 F56
Holdings: v.1:no.1 (1973:spring)-v.10:no.4 (1982:Nov.) [LOCATE](#)

Item in place (0 requests) v.6-v.10 (1978-1982)
May be loanable **Note: From the Florida Ornithological Society Records.**
Material Type: Bound Issue [Request for Reading Room Use](#)
Location: USF SPECIAL COLLECTIONS-Tampa
Environmental and Natural History Collection
QL684.F6 F56
Barcode: 32102046324667

Item in place (0 requests) v.1-v.5 (1973-1977)
May be loanable **Note: From the Florida Ornithological Society Records.**
Material Type: Bound Issue [Request for Reading Room Use](#)
Location: USF SPECIAL COLLECTIONS-Tampa
Environmental and Natural History Collection
QL684.F6 F56
Barcode: 32102046324683

[Collapse All](#)

Additional Description

Bibliography
[Go To Catalog Record](#)

General
Includes the following holdings: v.1:no.1 (1973:spring)-v.10:no.4 (1982:Nov.).

Physical Storage Information

- Object **ENVR QL684.F6 F56 (Text)**

Emphasizing the 'H' in FLENH

- Reaching a new audience
- Embedding resources in instruction
- Serving traditional departments: History and English
- Connections between strategic collecting areas



Topics in Environmental History

HIS 3002 - Research and Methods

Explore





Bridge over Hillsboro River,
Tampa, Fla.

The River Widening: Students & FLENH

- Metadata
 - Research
 - Contextualizing collections
- "The human side of scientific study"
 - Connecting published papers to archival materials



Dr. Ogden Caribbean and Coral Reef Collection

- Researchers retiring, have accumulated materials from their careers
- Need for repositories to protect and share their collections
- Dr. Ogden influenced by colleagues who had donated their collections to libraries

Dr. Ogden Caribbean and Coral Reef Collection

- Metadata
 - Species identification
 - Research using field guides for marine species
 - Reading the text-based journals to understand the images

Image: Humann, P. (1994). *Reef Fish Identification: Florida, Caribbean, Bahamas*. N. DeLoach, Ed.

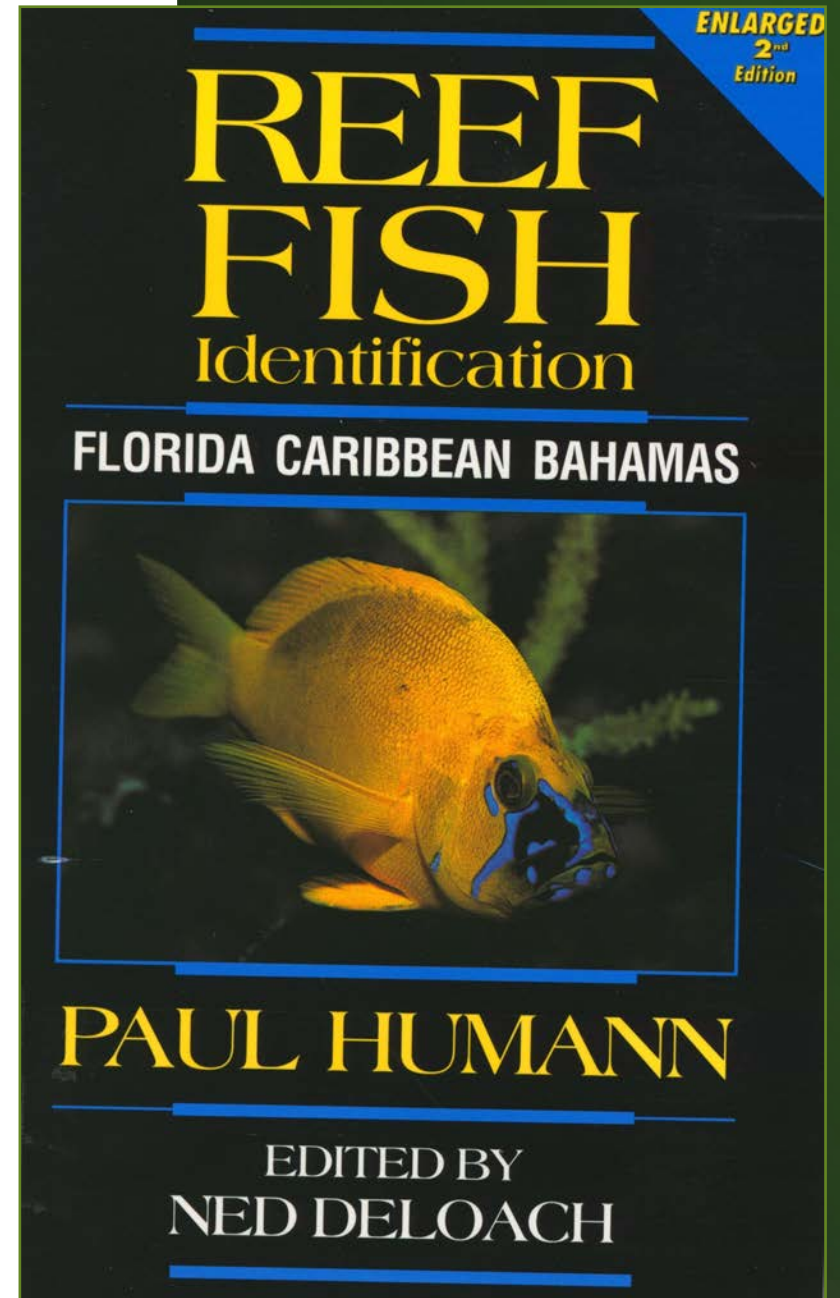

The Human Side of Scientific Study

- Connecting published papers to archival materials
- The Story of the Sea Turtle

- Journal Excerpt:

- "On the way back it [the turtle] would give heavy sighs and viscous tears rolled out of her eyes....The crew- generally a hard-bitten, cynical lot has cast their lot with the turtle. There is a movement building and the dissection had better get going before it peaks."

Symbiotic Cellulose Degradation in Green Turtles, *Chelonia mydas* L.

T. M. FENCHEL,¹* C. P. MCROY,² J. C. OGDEN,³ P. PARKER,⁴ AND W. E. RAINEY⁵

*Institute of Ecology and Genetics, University of Aarhus, DK-8000 Aarhus C, Denmark*¹; *Institute of Marine Science, University of Alaska, Fairbanks, Alaska 99701*²; *West Indies Laboratory, Christiansted, St. Croix, U.S. Virgin Islands 00820*³; *Marine Science Institute, University of Texas, Port Aransas, Texas 78373*⁴; *Museum of Vertebrate Zoology, University of California, Berkeley, California 94720*⁵

Received for publication 4 December 1978

sea - 1.5 hrs. The
and appealing. On the way back it
would give heavy sighs and viscous tears
rolled out of her eyes. We arrived at
the ship and heaved her out in a cargo
net. The crew- generally a hard-bitten
cynical lot - have over the past few
mons cast their lot with the turtle.
There is a movement building and
the dissection had better get going before
it peaks.

Florida Ornithological Society - Processing

- Transferring to Hollinger Boxes
 - Retaining order
- Building the finding aid
 - Increasing access for FOS members and the public
- Future potential for increased metadata
 - Identifying those in photographs
 - Providing additional context about the material
- Image: Dusky Seaside Sparrow, Nesting Record, FOS Collection

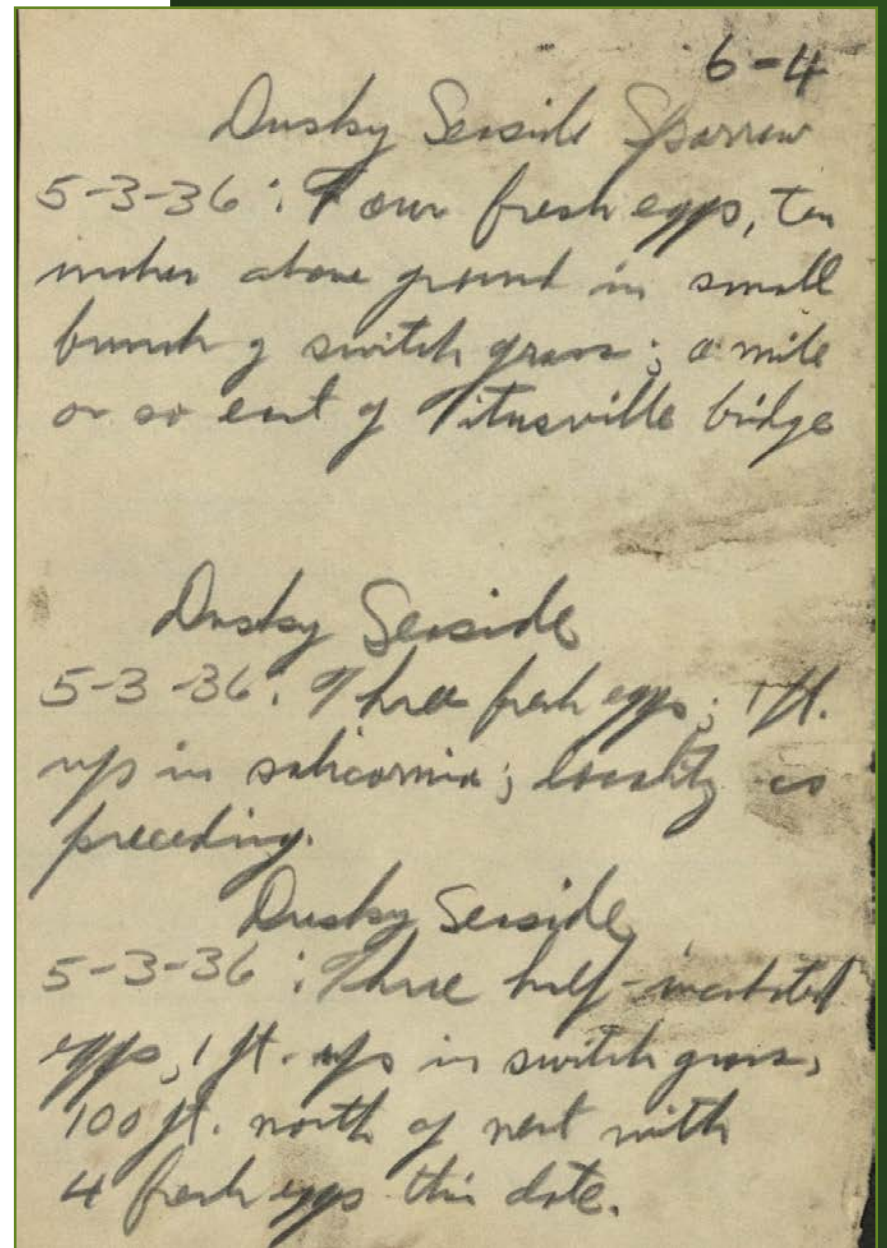

Highlighting Significance

- Supporting the FOS
 - Curating materials for their 50th anniversary celebration
- Researching what Florida bird populations have been like in the past
 - Able to inform current policies and conservation efforts
- The Dusky Seaside Sparrow
 - Photo credit: USFWS/Science Source



Downstream – FLENH Goes Digital

FLENH

The Florida Environment & Natural History Portal

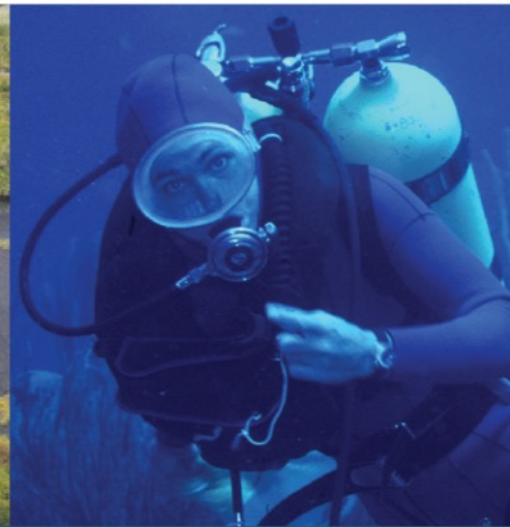

Nesting Access Points

- Special Collections
- Digital Collections
- Calling : Earth
- Faculty Publications
- Digital Exhibits
- Data Management Access
- Partner Resources

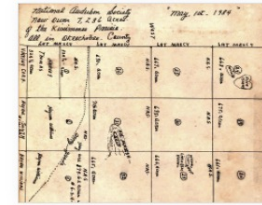

Audubon Florida Records, 1900-1970

This digital collection contains the daily journals of Audubon wardens and statewide reports on certain sites and projects cover activities from 1900 to 1970, with most of the materials concentrated between the 1930s and 1950s.

[Examine the Collection](#)



The Center for the Integrated Modeling and Analysis of the Gulf Ecosystem (C-IMAGE) Collection

The Center for Integrated Modeling and Analysis of Gulf Ecosystems (C-IMAGE) was a research consortium of 19 U.S. and international partners focused on effects of oil spills on marine environments. The C-IMAGE consortium completed an unprecedented study of the Deepwater Horizon blowout of 2010 through funding from the Gulf of Mexico Research Initiative (GoMRI). The overarching objective of C-IMAGE was to advance understanding of marine blowouts as response agencies and production companies were underprepared to deal with the unique challenges of Deepwater Horizon. Data is made freely available to ensure society is better prepared to mitigate any future occurrences.

[Examine the Collection](#)



The Catesby Collection

Selected plates from Mark Catesby's *Catesby, Mark, and George Edwards. The Natural History of Carolina, Florida, and the Bahama Islands: Containing the Figures of Birds, Beasts, Fishes, Serpents, Insects, and Plants: Particularly the Forest-Trees, Shrubs, and Other Plants, Not Hitherto Described, or Very Incorrectly Figured by Authors: Together with Their Descriptions in English and French: to Which Are Added, Observations on the Air, Soil, and Waters: with Remarks Upon Agriculture, Grain, Pulse, Roots, &c.: to the Whole Is Prefixed a New and Correct Map of the Countries Treated of.* London: Printed for Charles Marsh ... Thomas Wilcox ... and Benjamin Stichall, 1754. Print.

[Examine the Collection](#)

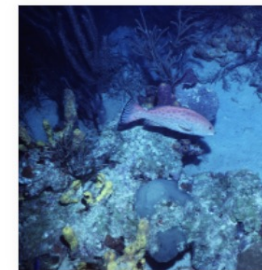

Dr. John Ogden Florida and Caribbean Reef Collection

This collection consists of over 30 years of data from USF marine science professor, Dr. John Ogden's research excursions throughout the Caribbean. Dr. Ogden's extensive fieldwork documents changes in coral reef condition and the flora and fauna that depend on this fragile underwater ecosystem. The content includes field diaries and notes, illustrations, maps, charts, and photographs of reef, seagrass and mangrove habitats that support a wide range of marine species, including grey and yellowtail snapper, grunts, parrotfish, sea turtles, starfish and sea urchin.

[Examine the Collection](#)



Environmental Lands Acquisition and Protection Program Collection

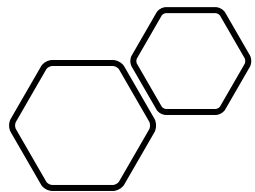

New Pathways – Eco-Literacies for Climate Action in Florida

- Environmental literature meets the archives
- Grant-funded partnership
- Multi-modal K-16+ educator resources



ALA American Library Association



USF
UNIVERSITY OF
SOUTH FLORIDA
COLLEGE OF EDUCATION



UNIVERSITY of
SOUTH FLORIDA
Libraries



CITL
Center for Innovative
Teaching and Learning

Digitization Investments

- Prioritizing FLENH materials
 - Data
 - Water
 - Ornithology
- Outsourcing
- In-house digitization
- Accessibility

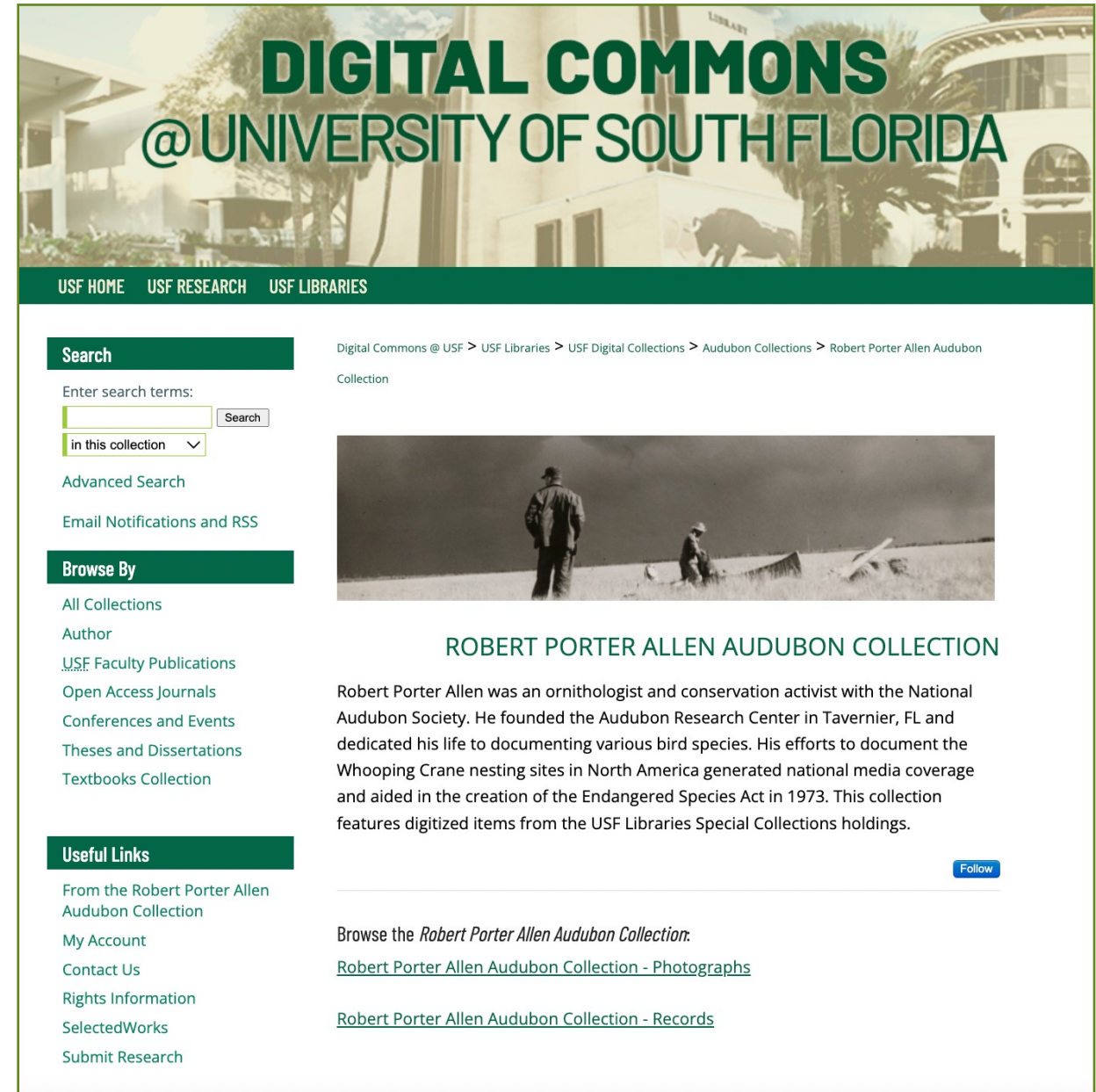

DIGITAL COMMONS
@ UNIVERSITY OF SOUTH FLORIDA

USF HOME USF RESEARCH USF LIBRARIES

Digital Commons @ USF > USF Libraries > USF Digital Collections > Audubon Collections > Robert Porter Allen Audubon Collection

Collection

Enter search terms:
 Search
in this collection ▾

Advanced Search
Email Notifications and RSS

Browse By

- All Collections
- Author
- USF Faculty Publications
- Open Access Journals
- Conferences and Events
- Theses and Dissertations
- Textbooks Collection

Useful Links

- From the Robert Porter Allen Audubon Collection
- My Account
- Contact Us
- Rights Information
- SelectedWorks
- Submit Research



ROBERT PORTER ALLEN AUDUBON COLLECTION

Robert Porter Allen was an ornithologist and conservation activist with the National Audubon Society. He founded the Audubon Research Center in Tavernier, FL and dedicated his life to documenting various bird species. His efforts to document the Whooping Crane nesting sites in North America generated national media coverage and aided in the creation of the Endangered Species Act in 1973. This collection features digitized items from the USF Libraries Special Collections holdings.

[Follow](#)

Browse the *Robert Porter Allen Audubon Collection*:
[Robert Porter Allen Audubon Collection - Photographs](#)
[Robert Porter Allen Audubon Collection - Records](#)



Lessons Learned? Adapt & Evolve

Questions?



UNIVERSITY of
SOUTH FLORIDA

Libraries